

362

1-369 50,000Rs.



2-00
1102408
5
33
ST-5000/-

19718001 4870

ADMISSION under Rule 81 and
under Section 1 of the W.B.L.R.
Act 1957 duly stamped under
the Indian Stamp Act 1899
and in the No. _____
of the Part _____

19718001 - Rs. 5000/-
under Rule 81 of the W.B.L.R.
Act 1957 and duly stamped
under the Indian Stamp Act 1899
also Certifies that the Deficit Stamp
of Rs. 4870/- is
realized under the
provisions of S. 49 of the
Act 42/47 (A) of I.S. Act-1297
vide the Chaitan/Bankor's Cheque
No. 1012935290
of the date 1.2.08
1.2.08

10,00,000/-
A-10989/-
10/10/08
10/10/08
1.2.08

Additional District Sub-Registrar
Badar, Paschim Medinipur,
1.2.08

P. feel of
A-10989

Additional District Sub-Registrar
Badar, Paschim Medinipur
12/08

21681
10989
10692

✓ टाँका. नरेश भूरा
उप. अधिकारी डि. बरीलारा
2100, 2108, 32102 नं. 5/8
उन. उपा. बरीलारा 23/08/08
उ. 80 नं. 10/08/08
उप. अधिकारी 2100 नं. 5/8
नम. नम. 21030 0.0 5/8/08
उ. अधिकारी नम. नम. 21030
कुल: 20, 00000. 00 रु. का

10/10/08

1087 2000
 ডি. স্ট্যাম্প ক্রমিক নং..... টাকা.....
 25/10/08 জেলা- পশ্চিম মেদিনীপুর
 ম. (মি) প্রমোদ কুমার
 ক্রমিক নং.....
 ক্রমিক নং.....
 গকঘর.....
 গানা.....
 সাক্ষর.....
 স্ট্যাম্প ডেভার সোমনাথ দাস
 কালেক্টরেট কোর্ট, পশ্চিম মেদিনীপুর



Registration
 25/10/08 AD/PUR on the day of 1st
 Feb 2008 at the
 Office of the AD/SR, Midnapore
 Prangopal Pal

10000/- 2 10000/-

শ্রী প্রমোদ কুমার

Prangopal Pal
 Ram Chandra Behari Pal
 Ram Chandra Pal
 Ram Chandra Pal
 Ram Chandra Pal
 Ram Chandra Pal

Additional District Sub-Registrar
 Sadar, Paschim Medinipur
 11/2/08

Signature

শ্রী প্রমোদ কুমার

Sabyasachi Pal
 Prangopal Pal
 Ram Chandra Pal
 Ram Chandra Pal
 Ram Chandra Pal
 Ram Chandra Pal



622

শ্রী প্রমোদ কুমার
 মিঃ - শ্রী প্রমোদ কুমার
 বিজ্ঞান - মোঃ আমজাদ হোসেন
 মেসার্স - (মেদিনীপুর (মি))

Additional District Sub-Registrar
 Sadar, Paschim Medinipur
 11/2/08



ମନ ମାମୁଳା ନିମ୍ନ ପ୍ରକାର:-

ଶ୍ରୀମତୀ ଲକ୍ଷ୍ମୀ ଦେବୀଙ୍କୁ ଯୋଗ୍ୟ ଭାବେ
 ଆଣି ଆଣି ସ୍ୱାମୀଙ୍କୁ ଯୋଗ୍ୟ ଭାବେ
 ଯାଦି ଦିଆ ଯାଉଥିବା ସମୟରେ
 ଆମ ଉପାଦାନ ସମୟ ୧୦-୧୫
 ମାସ ଯାଏଁ ଯାଏ. ଯଦି ଯାଏ
 ସମୟ ସମୟରେ ଯଦି ଯାଏ
 ଯଦି ଯାଏ ଯଦି ଯାଏ.

ଲକ୍ଷ୍ମୀ-ଲକ୍ଷ୍ମୀ-ଲକ୍ଷ୍ମୀ-ଲକ୍ଷ୍ମୀ

ମନ ମାମୁଳା ନିମ୍ନ ପ୍ରକାର:-

ଶ୍ରୀମତୀ ଲକ୍ଷ୍ମୀ ଦେବୀଙ୍କୁ ଯୋଗ୍ୟ ଭାବେ
 ଆଣି ଆଣି ସ୍ୱାମୀଙ୍କୁ ଯୋଗ୍ୟ ଭାବେ
 ଯାଦି ଦିଆ ଯାଉଥିବା ସମୟରେ
 ଆମ ଉପାଦାନ ସମୟ ୧୦-୧୫
 ମାସ ଯାଏଁ ଯାଏ. ଯଦି ଯାଏ
 ସମୟ ସମୟରେ ଯଦି ଯାଏ
 ଯଦି ଯାଏ ଯଦି ଯାଏ.

ଯଦି ଯାଏ ଯଦି ଯାଏ ଯଦି ଯାଏ
 ଯଦି ଯାଏ ଯଦି ଯାଏ ଯଦି ଯାଏ
 ଯଦି ଯାଏ ଯଦି ଯାଏ ଯଦି ଯାଏ



Additional District Sub Registrar
Sadar, Paschim Medinipur

12/08



Additional District Sub Registrar
Sadar, Paschim Medinipur

112108



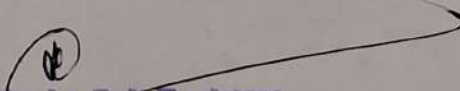

Additional District Sub-Registrar

Sadar, Paschim Medinipur

11/2/08



Additional District Sub Registrar
Sadar, Paschim Medinipur

112108

[Faint, illegible handwritten text]



Additional District Sub Registrar
Sadar, Paschim Medinipur

112/08

ଅନୁମୋଦିତ ଅଟେ ଓଡ଼ିଶା ଲୋକସେବା ସମିତି



ଅନୁମୋଦିତ ଅଟେ ଓଡ଼ିଶା ଲୋକସେବା ସମିତି



ଅନୁମୋଦିତ ଅଟେ ଓଡ଼ିଶା ଲୋକସେବା ସମିତି

Indu Kishor De.

ଅନୁମୋଦିତ ଅଟେ ଓଡ଼ିଶା ଲୋକସେବା ସମିତି



ଅନୁମୋଦିତ ଅଟେ ଓଡ଼ିଶା ଲୋକସେବା ସମିତି



ଅନୁମୋଦିତ ଅଟେ ଓଡ଼ିଶା ଲୋକସେବା ସମିତି

ଅନୁମୋଦିତ ଅଟେ ଓଡ଼ିଶା ଲୋକସେବା ସମିତି



(Signature)
Additional District Sub-Registrar
Sadar, Paschim Medinipur
1/21/08



(Signature)
Additional District Sub-Registrar
Sadar, Paschim Medinipur
7-2-08

(Signature)
Book.....
Volume No..... 15
Page No..... 131 to 138
Being No..... 369
of the year..... 2008

ORIGINAL
MOUZA-NARAMPUR. J.L. NO-174.

P.S.-MEDINIPUR. DIST-PASCHIM-MEDINIPUR.

SCALE- 48" = 1 MILE.

DONEE:- SMT. INDULEKHA DEY. W/O LATE SATEYENDRA
NATH DEY. OF AUROVINDA NAGAR. P.O. & P.S.-MEDINIPUR.
DIST-PASCHIM-MEDINIPUR.

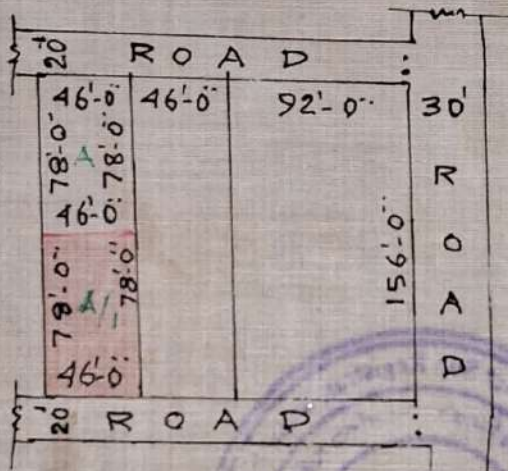

Handwritten notes in blue ink: 'NORTH BOUNDARY 92'-0" WITH THE' and 'NORTH BOUNDARY 30' WITH THE'.

Vertical stamp: 'Surveyor, Paschim Medinipur' and 'Additional District Sub-Registrar'.

Additional District Sub-Registrar
Paschim Medinipur

DRAWN BY:

G. N. Sahoo

G. N. Sahoo.
Surveyor-Pashkar. (Retd.)
Govt. of West Bengal &
Ex-Survey Inspector.
Govt. of (Bihar)

REFERENCES

GIFTED LAND SHOWN THUS.. A/1
R. S. PLOT NO- 43 (PART)
AND L. R. PLOT NO-
AND MARKED-A/1
AREA- 3588 SQFT = 0.0825 ACRE.
(MORE OR LESS)

Additional District Sub-Registrar
Badar, Paschim Medinipur
07-2-08



Additional District Sub-Registrar
Badar, Paschim Medinipur

Serial No. 15
Volume No. 131
Page No. 369
Date 2008

G. R. Sahoo,
Surveyor-Pastor (Rtd.),
Govt. of West Bengal &
Ex-Survey Inspector,
Govt. of Bihar